

WHATCOM COUNTY COUNCIL AGENDA BILL

NO. _____ 2018-137

CLEARANCES	Initial	Date	Date Received in Council Office	Agenda Date	Assigned to:
Originator:	JPR	4/11/18	RECEIVED APR 16 2018 County Council	4/24/18	PW Comm - Introduction
Division Head:	JPR	4/11/18		5/8/18	Council - Hearing
Dept. Head:	AT	4/12/18		5/22/2018	Public Hearing
Prosecutor:	KNF	4/12/18			
Purchasing/Budget:					
Executive:	TM	4.16.18			

TITLE OF DOCUMENT:
An Ordinance Regarding Establishment of Speed Limits on certain roads in the Birch Bay area.

- ATTACHMENTS:**
1. *Memo to County Executive and County Council*
 2. *Map A-D*
 3. *Speed Limit Ordinance*

SEPA review required? () Yes (X) NO	Should Clerk schedule a hearing? (X) Yes () NO
SEPA review completed? () Yes (X) NO	Requested Date 5/8/2018

SUMMARY STATEMENT OR LEGAL NOTICE LANGUAGE: *(If this item is an ordinance or requires a public hearing, you must provide the language for use in the required public notice. Be specific and cite RCW or WCC as appropriate. Be clear in explaining the intent of the action.)*

To comply with RCW 46.61.415, at the direction of the County Council, it is found necessary and expedient to modify the speed limits on certain roads in the Birch Bay area.

<p>COMMITTEE ACTION:</p> <p>4/24/2018: Discussed</p>	<p>COUNCIL ACTION:</p> <p>4/24/2018: Introduced 6-0, Byrd absent 5/8/2018: Held in Council, public hearing scheduled in two weeks</p>
---	---

Related County Contract #:	Related File Numbers:	Ordinance or Resolution Number:
-----------------------------------	------------------------------	--

Please Note: *Once adopted and signed, ordinances and resolutions are available for viewing and printing on the County's website at: www.co.whatcom.wa.us/council.*

**WHATCOM COUNTY
PUBLIC WORKS DEPARTMENT**

Jon Hutchings
Director



Joseph P. Rutan, P.E.
County Engineer/Assistant Director
322 N. Commercial Street, Ste 301
Bellingham, WA 98225-4042
Phone: (360) 778-6210
Fax: (360) 778-6211

Memorandum

RECEIVED

To: The Honorable Jack Louws, County Executive, and
Honorable Members of the Whatcom County Council

APR 12 2018

Through: Jon Hutchings, Director *JH*

JACK LOUWS
COUNTY EXECUTIVE

From: Joseph P. Rutan, P.E., County Engineer/Assistant Director *JPR*

Date: April 11, 2018

Re: Ordinance Regarding Designation of Speed Limits for Certain Birch Bay
Area Roads as 25 mph.

Requested Action:

Adoption of an ordinance to designate the speed limit on certain Birch Bay area roads as 25 mph.

Background and Purpose:

The Birch Bay Chamber of Commerce has requested to designate Birch Bay Drive and all 25 mph roads leading to, and contiguous with, Birch Bay Drive as a golf cart zone per RCW 46.08.175. Several existing roads within this proposed zone are commonly understood to be 25 mph although they do not have an ordinance designating them as such. (See attached maps)

Additional Information:

RCW 46.08.175 requires that a roadway designated as a golf cart zone have a posted speed limit of 25 mph or less.

Per Whatcom County Ordinance 87-27, all County roads are 35 mph unless otherwise designated.



ATTACHMENT "A"

DEPARTMENT OF PUBLIC WORKS
322 N. COMMERCIAL ST., SUITE 301
BELLINGHAM, WA 98225
(360) 778-6210

SITUATE IN A PORTION OF SECTION 24
TOWNSHIP 40 NORTH, RANGE 1 WEST, W.M.
WHATCOM COUNTY, WASHINGTON

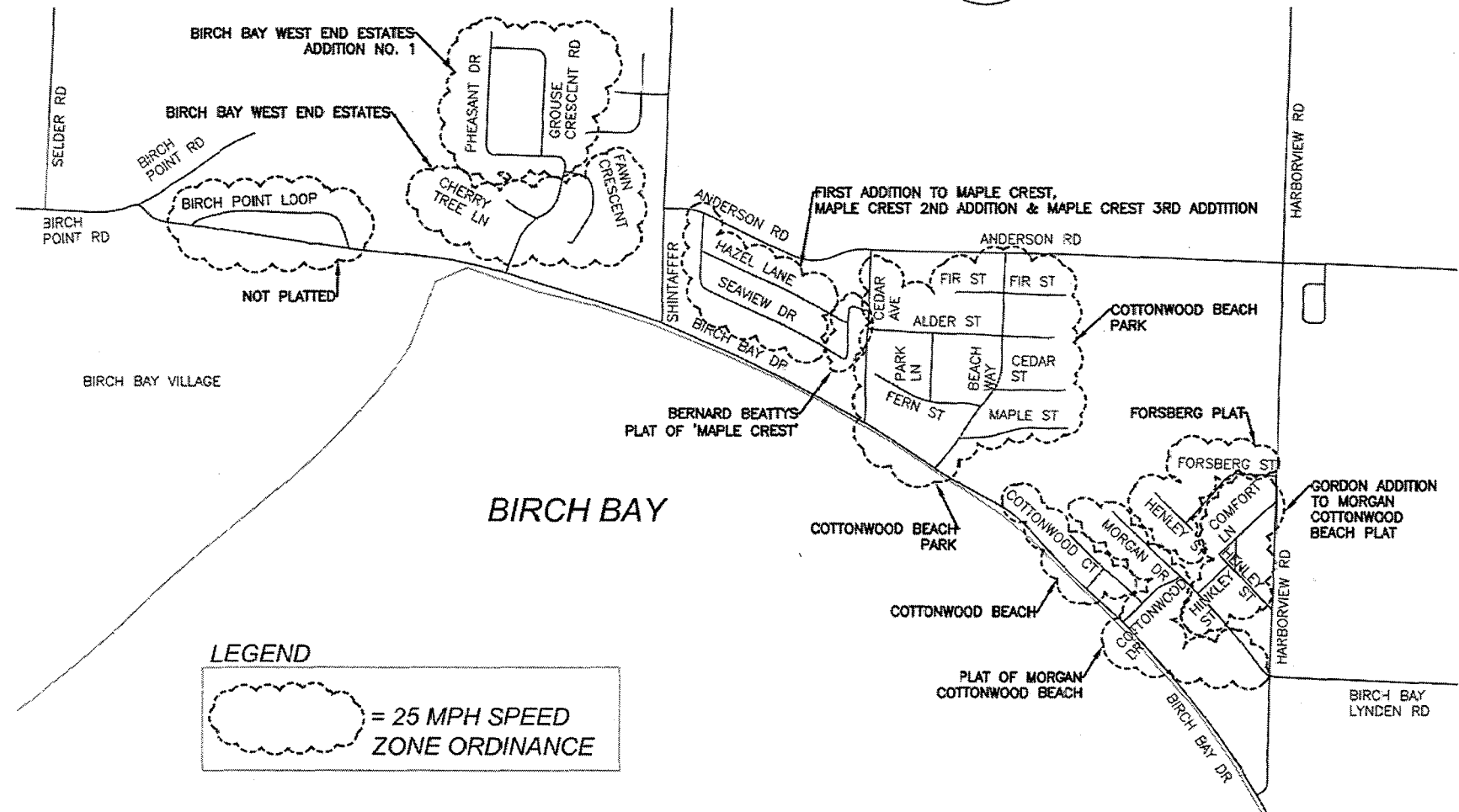

LEGEND
= 25 MPH SPEED ZONE ORDINANCE

SEE ATTACHMENT "B"



ATTACHMENT "B"

DEPARTMENT OF PUBLIC WORKS
322 N. COMMERCIAL ST., SUITE 301
BELLINGHAM, WA 98225
(360) 778-6210

SITUATE IN A PORTION OF SECTION 24
TOWNSHIP 40 NORTH, RANGE 1 WEST, W.M.
WHATCOM COUNTY, WASHINGTON



SEE ATTACHMENT "A"

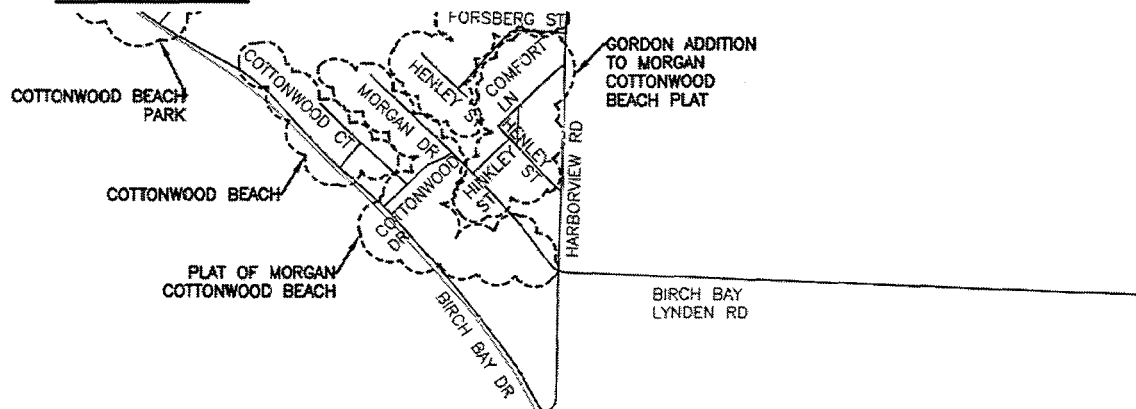

BIRCH BAY

LEGEND

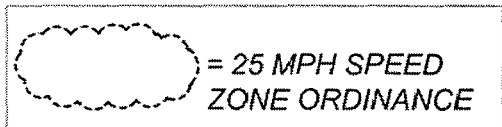

SEE ATTACHMENT "C"



ATTACHMENT "C"

SEE ATTACHMENT "B"

DEPARTMENT OF PUBLIC WORKS
322 N. COMMERCIAL ST., SUITE 301
BELLINGHAM, WA 98225
(360) 778-6210

SITUATE IN A PORTION OF SECTION 31
TOWNSHIP 40 NORTH, RANGE 1 EAST,
W.M & SECTION 36, TOWNSHIP
40 NORTH, RANGE 1 WEST, W.M
WHATCOM COUNTY, WASHINGTON

LEGEND

 = 25 MPH SPEED
ZONE ORDINANCE

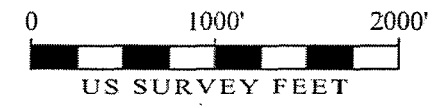

SEE ATTACHMENT "D"

BAY VIEW
TERRACE AMENDED

WHISPERING PINES & FIRST ADDITION
TO WHISPERING PINES

PARKLAND

BIRCH BAY

BIRCH BAY PARK

NOT PLATTED

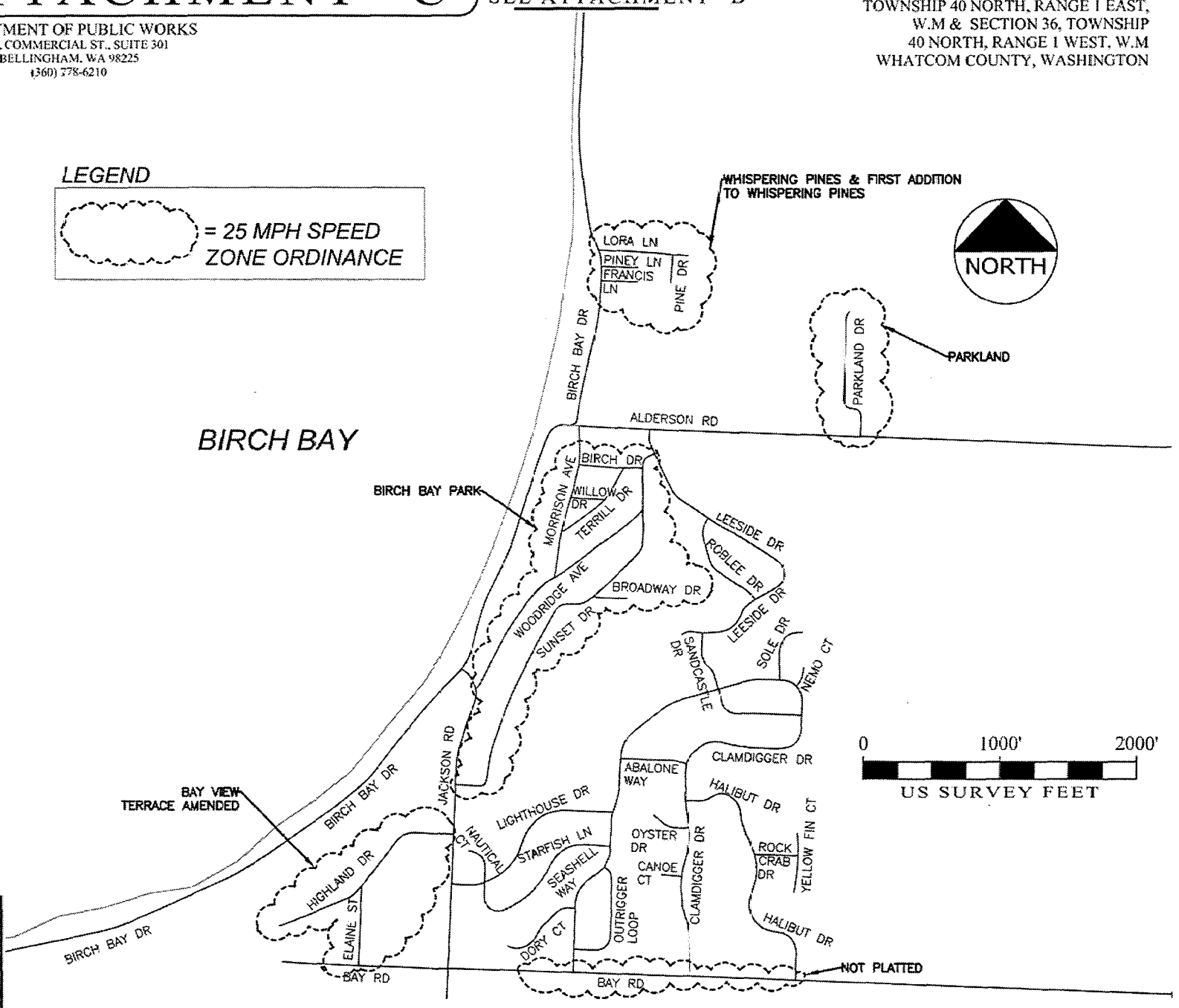



ATTACHMENT "D"

DEPARTMENT OF PUBLIC WORKS
322 N. COMMERCIAL ST., SUITE 301
BELLINGHAM, WA 98225
(360) 778-6210

SITUATE IN A PORTION OF SECTION 2
TOWNSHIP 39 NORTH, RANGE 1 WEST, W.M
WHATCOM COUNTY, WASHINGTON

LEGEND

 = 25 MPH SPEED
ZONE ORDINANCE

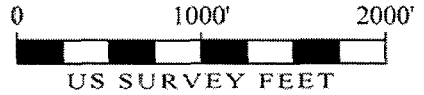

SEE ATTACHMENT "C"

BIRCH BAY

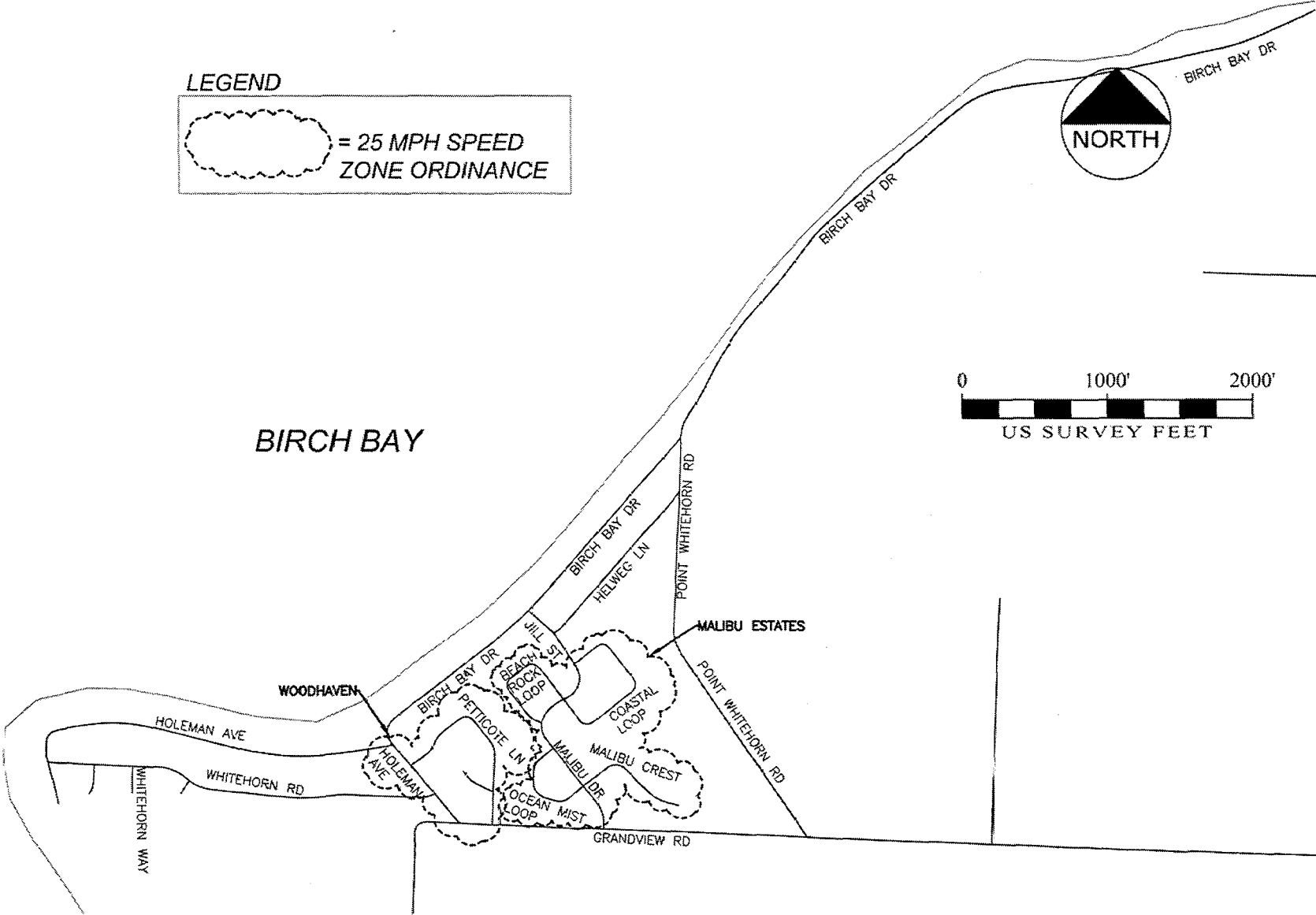

ORDINANCE NO. _____
ESTABLISHMENT OF 25 MPH SPEED LIMIT
ON CERTAIN BIRCH BAY AREA ROADS

WHEREAS, the Whatcom County Council is authorized under RCW 46.61.415 to establish speed limits on certain County roads; and

WHEREAS, the Birch Bay Chamber of Commerce has requested to designate Birch Bay Drive and all 25 mph roads that lead to, and are contiguous with, Birch Bay Drive as a Golf Cart Zone per RCW 46.08.175; and

WHEREAS, RCW 46.08.175 requires that roadways designated as golf cart zones must have a posted speed limit of 25 miles per hour or less;

NOW, THEREFORE, BE IT ORDAINED that the speed limits be established as follows:

1. 25 mph on Birch Point Loop
2. 25 mph on Bay road, from 500 feet East of Jackson road to Halibut Drive.
3. 25 mph on all roads within the plat of Maple Crest 2nd Addition, Section 24, Township 40 North, Range 1 West, W.M.
4. 25 mph on all roads within the plat of First Addition to Maple Crest, Section 24, Township 40 North, Range 1 West, W.M.
5. 25 mph on all roads within the plat of Maple Crest 3rd Addition, Section 24, Township 40 North, Range 1 West, W.M.
6. 25 mph on all roads within the plat of Bernard, Beattys plat of 'Maple Crest', Section 24, Township 40 North, Range 1 West, W.M.
7. 25 mph on all roads within the plat of Cottonwood Beach, Section 24, Township 40 North, Range 1 West, W.M.
8. 25 mph on all roads within the plat of Cottonwood Beach Park, Section 24, Township 40 North, Range 1 West, W.M.
9. 25 mph on all roads within the plat of Morgan Cottonwood Beach, Section 24, Township 40 North, Range 1 West, W.M.
10. 25 mph on all roads within the plat of Forsberg plat, Section 24, Township 40 North, Range 1 West, W.M.
11. 25 mph on all roads within the plat of Gordon Addition Morgan Cottonwood Beach Plat, Section 24, Township 40 North, Range 1 West, W.M.
12. 25 mph on all roads within the plat of Birch Bay West End Estates, Section 24, Township 40 North, Range 1 West, W.M.
13. 25 mph on all roads within the plat of Birch Bay West End Estates Addition No. 1, Section 24, Township 40 North, Range 1 West, W.M.
14. 25 mph on all roads within the plat of Birch Bay Park, Section 36, Township 40 North, Range 1 West, W.M.
15. 25 mph on all roads within the plat of Bay View Terrace Amended, Section 36, Township 40 North, Range 1 West, W.M.

16. 25 mph on all roads within the plat of Parkland, Section 31, Township 40 North, Range 1 East, W.M.
17. 25 mph on all roads within the plat of Birch Bay Park First Addition, Section 31, Township 40 North, Range 1 East, W.M.
18. 25 mph on all roads within the plat of First Addition to Whispering Pines, Section 31, Township 40 North, Range 1 East, W.M.
19. 25 mph on all roads within the plat of Whispering Pines, Section 31, Township 40 North, Range 1 East, W.M.
20. 25 mph on all roads within the plat of Malibu Estates, Section 2, Township 39 North, Range 1 West, W.M.
21. 25 mph on all roads within the plat of Woodhaven, Section 2, Township 39 North, Range 1 West, W.M.

BE IT FURTHER ORDAINED that the County Engineer is hereby directed to post the appropriate signs and that the Whatcom County Sheriff and the Washington State Patrol be notified by a copy of this ordinance.

Provisions of this ordinance are hereby added to Whatcom County Code, Section **10.04.**

ADOPTED this ____ day of _____, 2018.

ATTEST:

WHATCOM COUNTY COUNCIL
WHATCOM COUNTY, WASHINGTON

Dana Brown-Davis, Council Clerk

Rud Browne, Council Chair

APPROVED AS TO FORM:

Approved

Denied

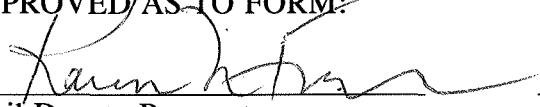

Civil Deputy Prosecutor

Jack Louws, Executive

Date: